

TYPICAL WHEEL STOP

SCALE: NTS

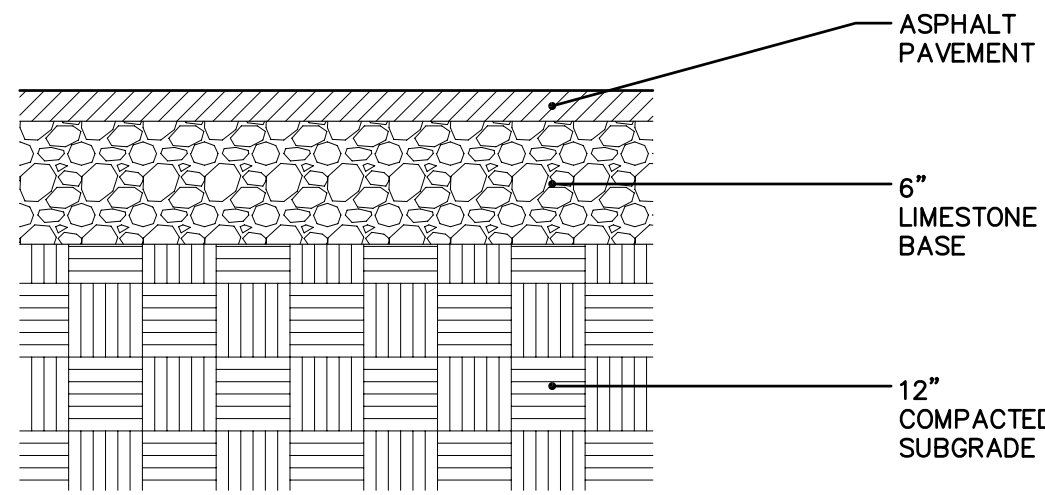

ASPHALT DETAIL

SCALE: NTS

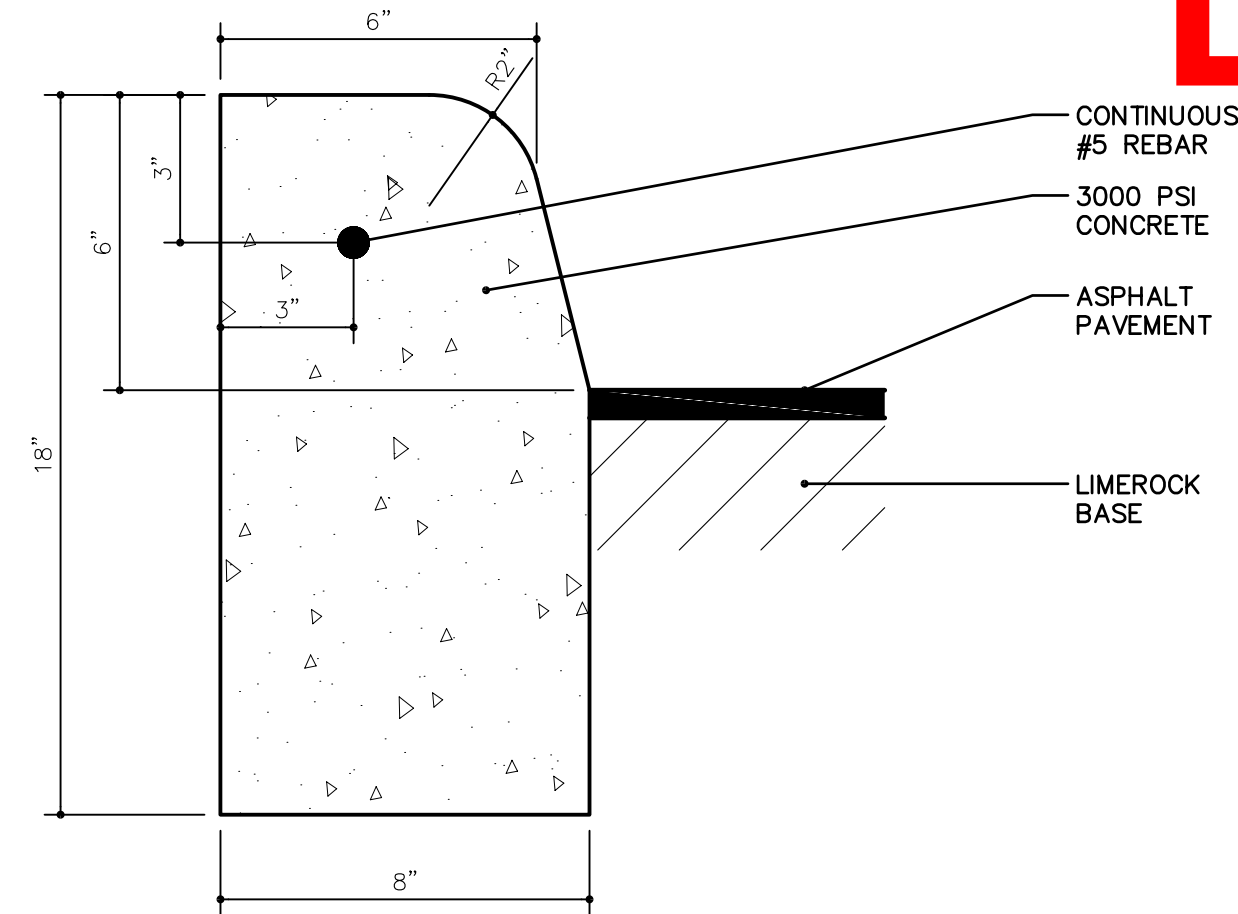

TYPE "D" CONCRETE CURB

SCALE: NTS

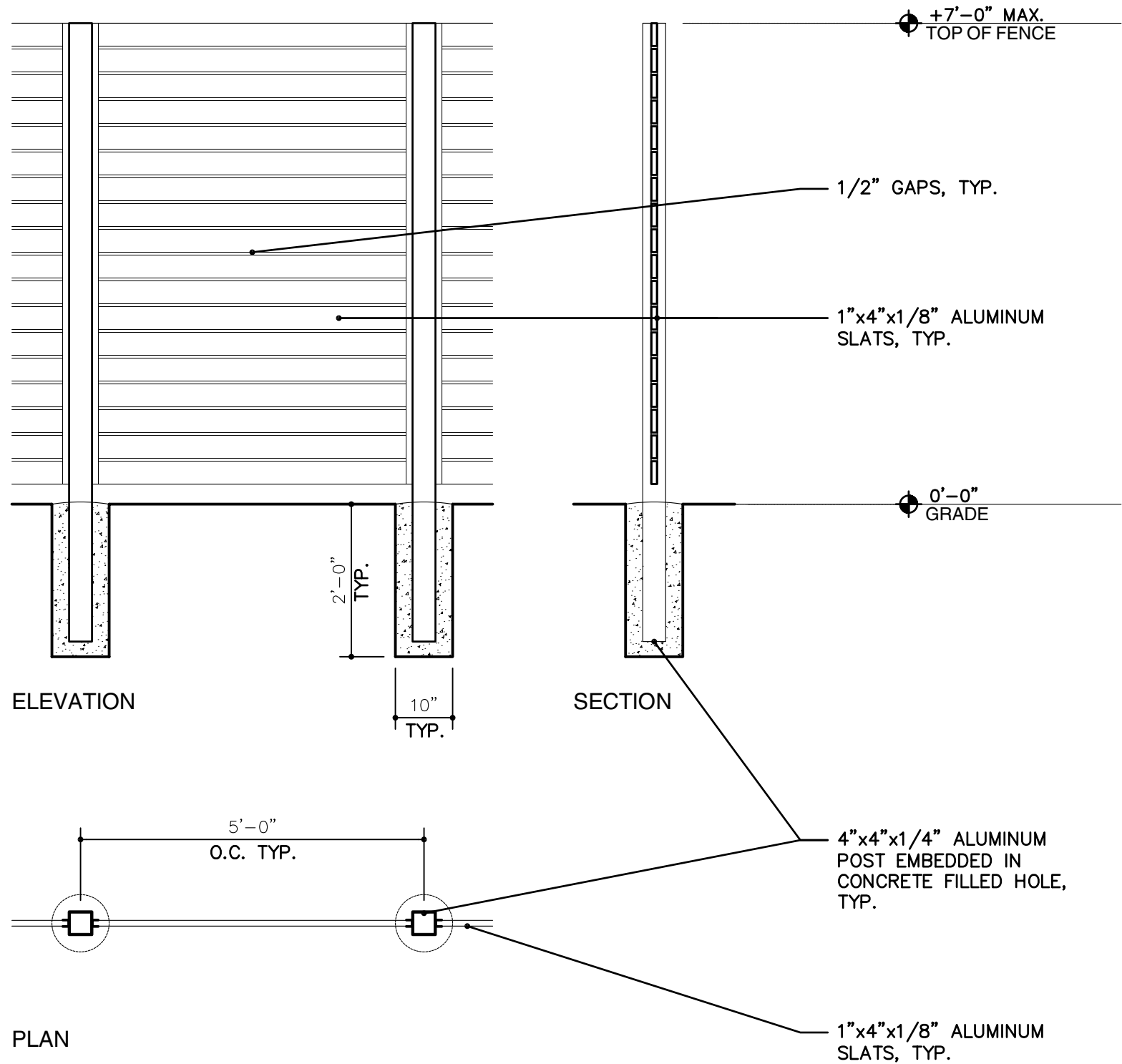
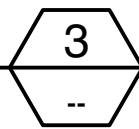

ALUMINUM FENCE DETAILS

SCALE: 1/2"=1'-0"

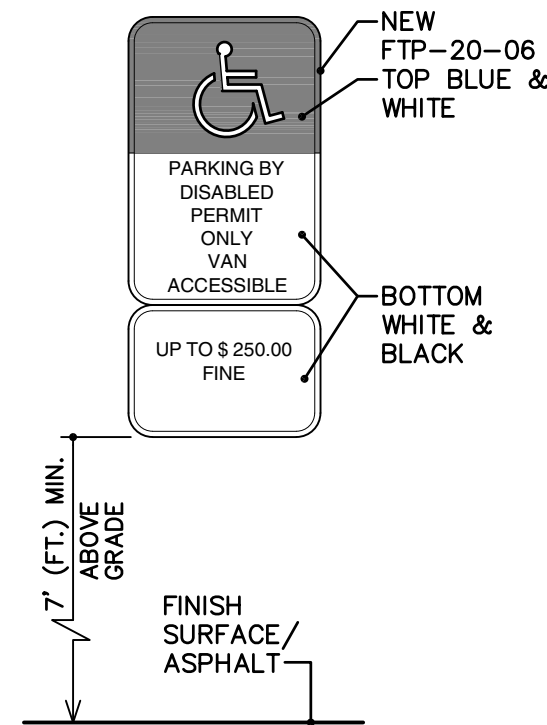
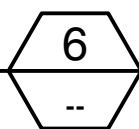

DISABLED PARKING DETAIL

SCALE: NTS

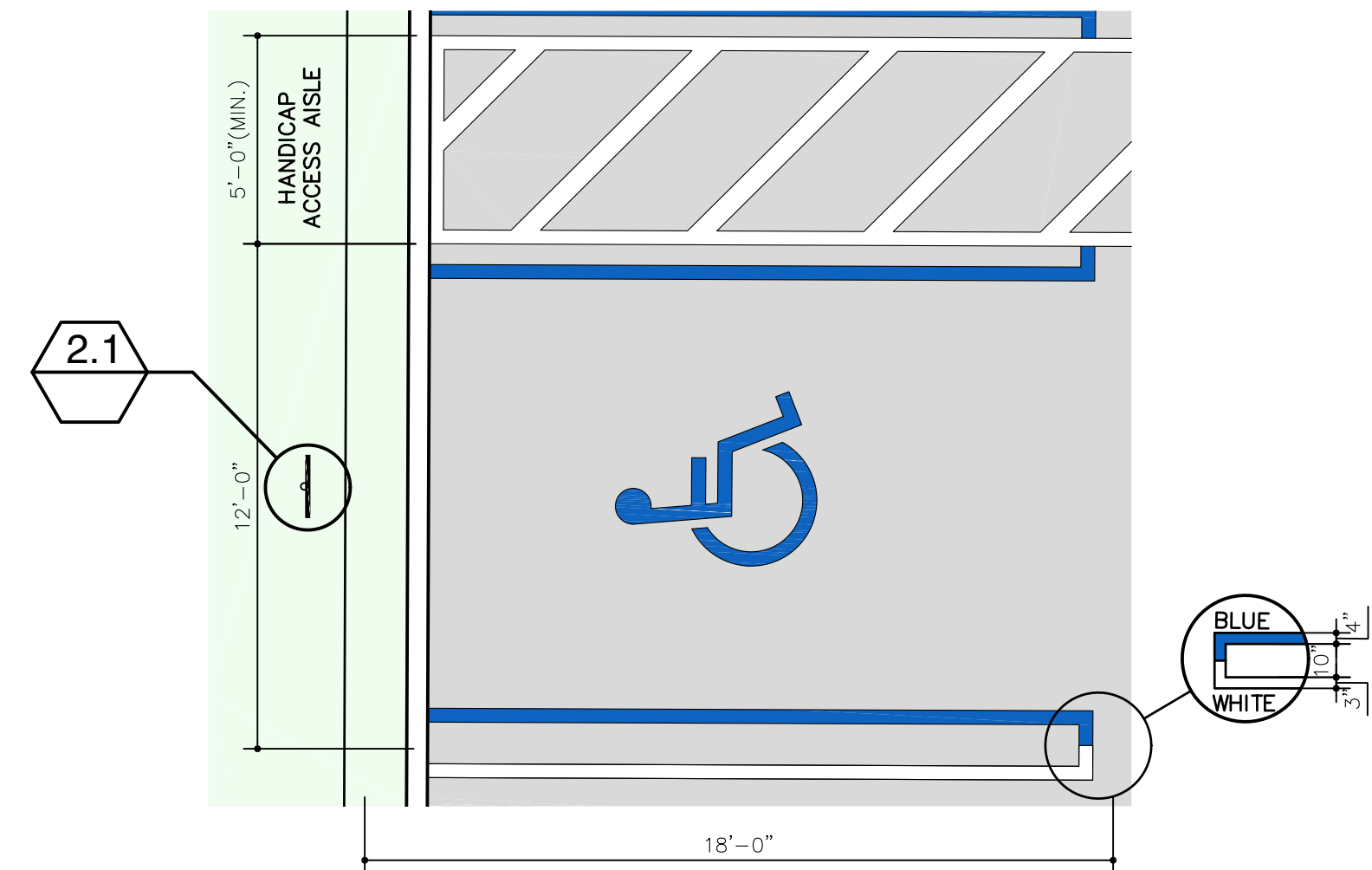
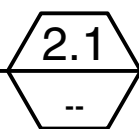

ADA PARKING STALL

SCALE: 1/4"=1'-0"

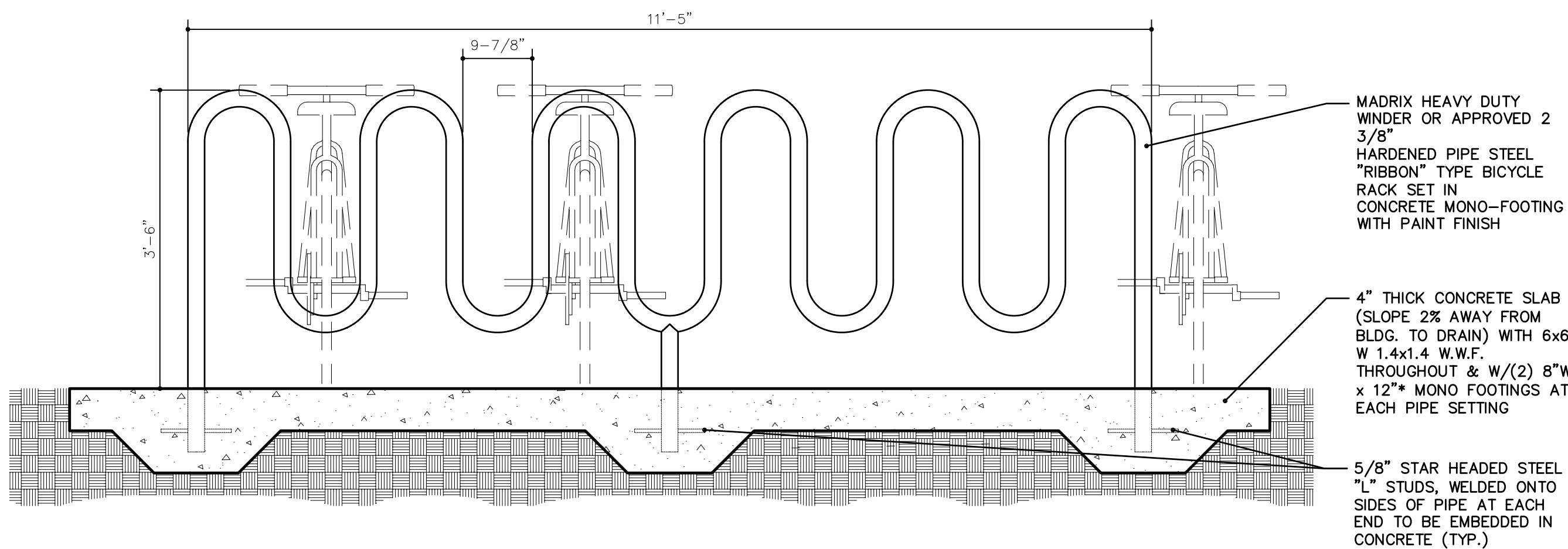
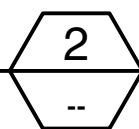

BICYCLE PARKING DETAIL

SCALE: 3/4"=1'-0"

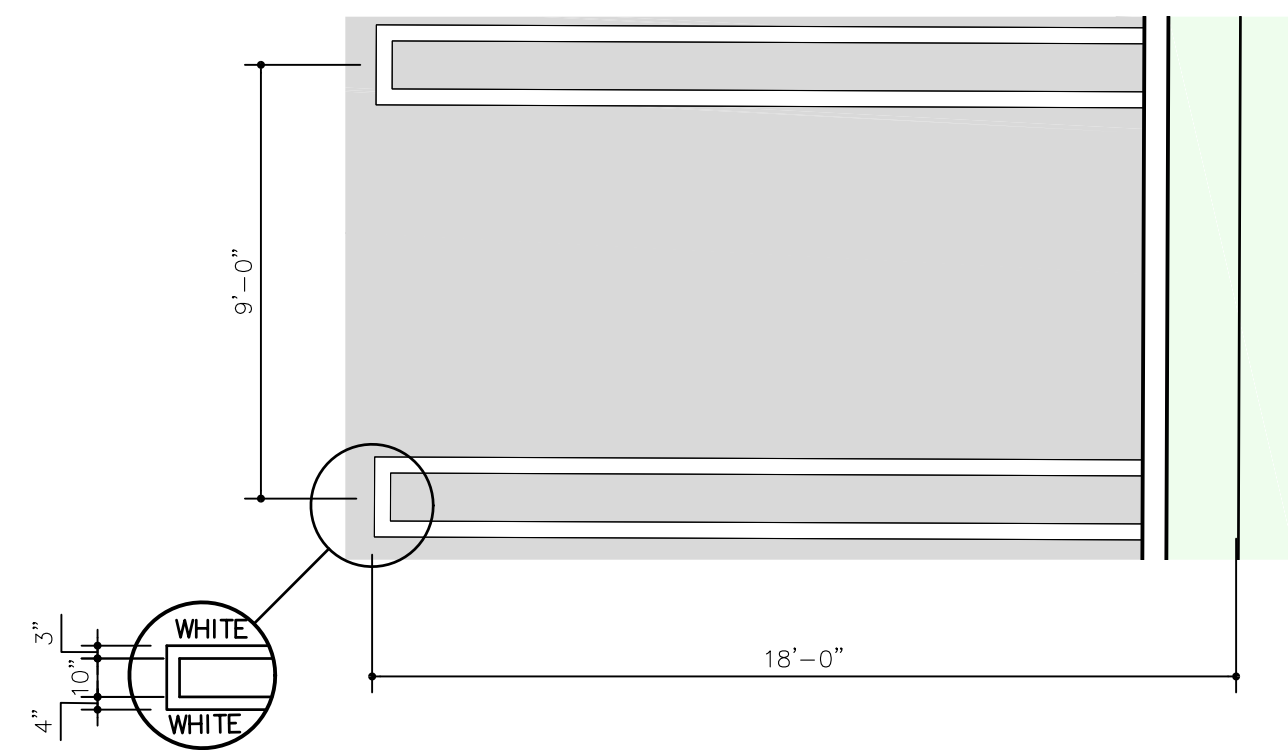

TYPICAL PARKING STALL

SCALE: 1/4"=1'-0"

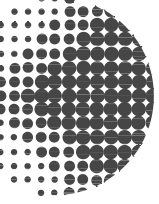
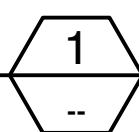

Digital  
signed by  
Daniel Alongi  
Date: 10/02/2024  
2024.09.22  
16:08:55 -0400'

01.25.23 LT DRC Review Submittal  
09.28.24 GC DRC Comment Response 1  
Job A2165  
Sheet 10.08.21

Consulting Engineer

Proposed Offices  
**Power Petroleum HQ**  
Owner: 201 SW 12 Ave, Inc.  
201 SW 12 Ave, Pompano Beach, 33069